

30 TON HEAVY DUTY SHOP PRESS

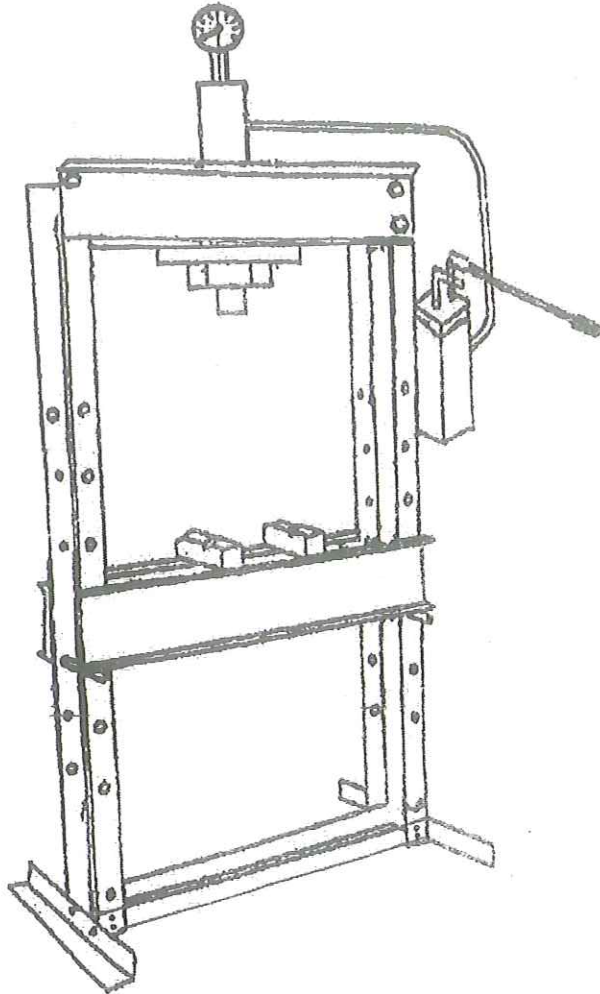

H-Style press
30-Ton Floor model

A NOTE ON SAFETY

We've done all we can to assure this press offers the utmost in safety, but you have to do your part. No amount of warning can take the place of your good judgment, so make sure it's the first thing you bring to any job. Beyond that here are some obvious tips:

Steel and other materials can shatter, so always use protective eyewear that complies with the appropriate ANSI code.

If you detect anything that may indicate imminent structural failure, stop using the press immediately and inspect it thoroughly.

Bolt the press to the floor if it is to be used on bulky or unstable items.

Do not use press to compress springs or any other item that could disengage and cause a potential hazard.

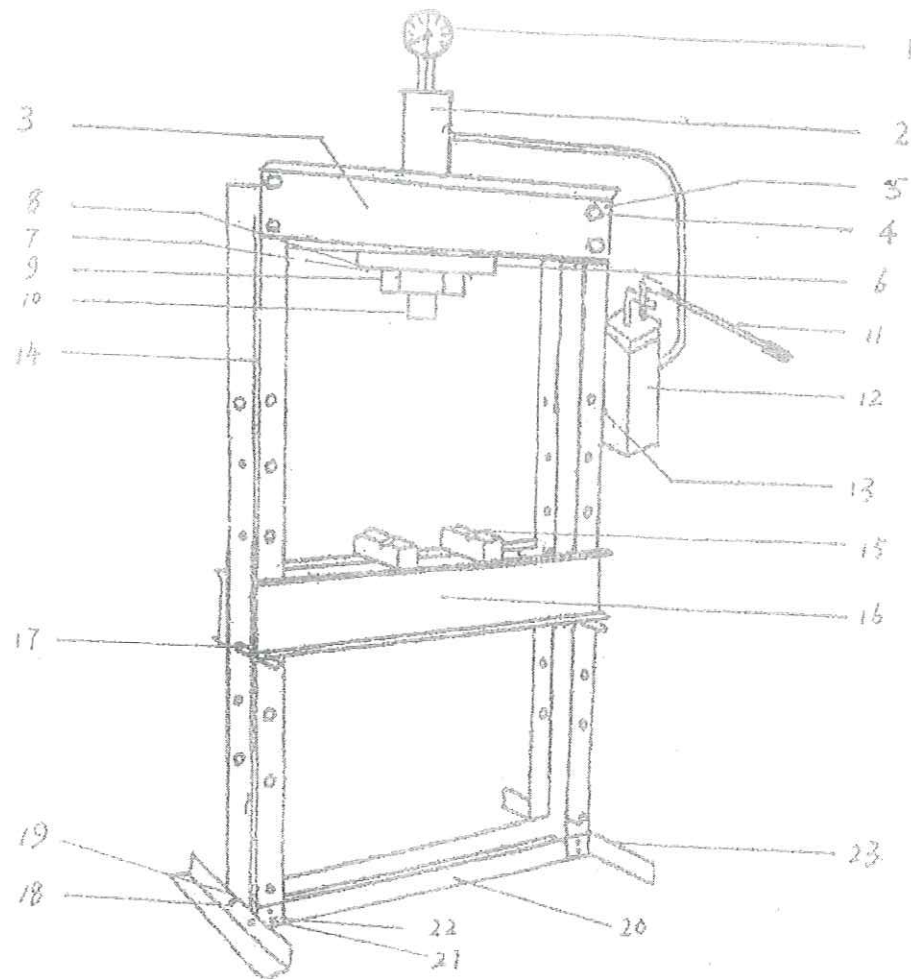

Parts No	Description	Q'ty	Parts No	Description	Q'ty
1	Gauge	1	13	Bolt M 10×2	2
2	Ram Assembly	1	14	Pole	2
3	Transom	2	15	Arbor plate	2
4	Bolt M20×45	8	16	Press platform	1
5	Flat Washer ϕ 20	8	17	Rod	2
6	Cylinder Assembly	1	18	Bolt M16×30	4
7	Bolt M10×50	4	19	Flat washer ϕ 16	4
8	Flat Washer ϕ 10	4	20	Spreader	2
9	Nut	1	21	Bolt M12×30	8
10	Pressure Head	1	22	Flat washer ϕ 12	8
11	Handle	1	23	Base Support	2
12	Pump Assembly	1			

30TON CYLINDER PARTS LIST

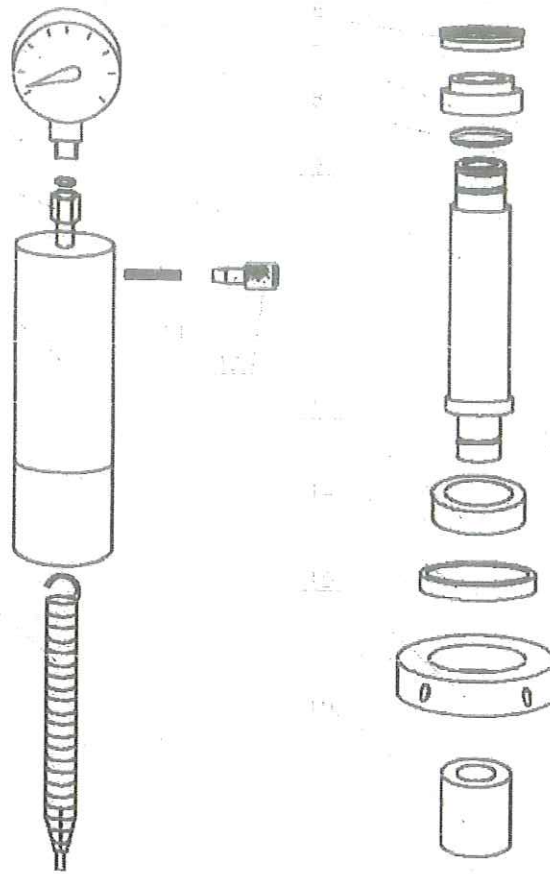

NO	DESCRIPTION	Q'TY	NO.	DESCRIPTION	Q'TY
1	GAUGE	1	10	SPRING PIN	1
2	NYLON-RING	1	11	COUPLING	1
3	BOLT	1	12	SCREW CAP	1
4	CYLINDER	1	13	TURNBUCKLE	1
5	SPRING	1	14	SCREW CAP	1
6	Y-RING	1	15	SCREW CAP	1
7	PISTON RING	1	16	ROD	1
8	O-RING	1			
9	PISTON	1			

30TON SHOP PRESS PUMP PARTS LIST

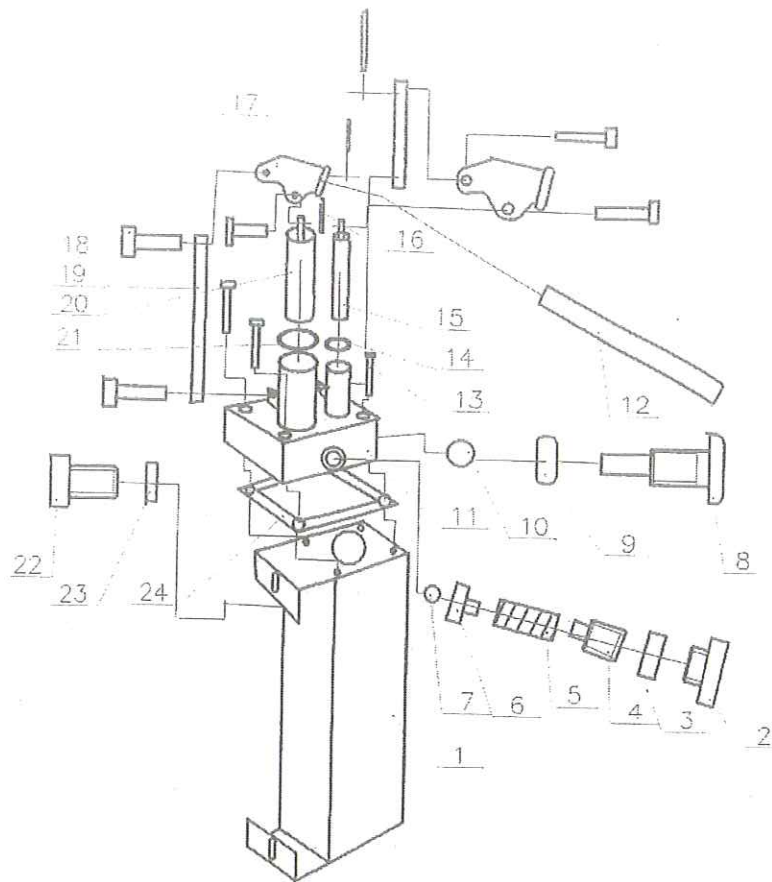

Parts No	Description	Q'ty
1	Oil tank	1
2	Sealed screw	1
3	Sealed ring	1
4	Pressure adjustment screw	1
5	pressure adjusment spring	1
6	Ball valve socket	1
7	Steel ball	1
8	Oil release plug	1
9	Sealed ring	1
10	Steel ball	1
11	Ram	1
12	Handle rod	1
13	Fixed screw	4
14	Sealed ring	1
15	Mlnt pumping core	1
16	Cotter pin	6
17	Lifting handle	2
18	Pin	6
19	Connecting rod	2
20	Big pumping core	1
21	Sealed ring	1
22	Oil injection screw	1
23	Sealed ring	1
24	Sealed ring	1

IMPORTANT

PLEASE READ THESE INSTRUCTIONS CAREFULLY. NOTE THE SAFETY INSTRUCTIONS AND WARNINGS. USE THE PRODUCT CORRECTLY AND WITH THE PURPOSE FOR WHICH IT IS INTENDED. FAILURE TO DO SO MAY CAUSE DAMAGE TO PROPERTY AND/OR SERIOUS PERSONAL INJURY. PLEASE KEEP THIS INSTRUCTION MANUAL SAFE FOR THE FUTURE USE.

I. SAFETY INSTRUCTIONS AND WARNINGS

1. USE A QUALIFIED PERSON TO MAINTAIN THE PRESS IN GOOD CONDITION. KEEP IT CLEAN FOR BEST AND SAFEST PERFORMANCE.
2. THE MAXIMUM LOAD IS 30 TONS. DO NOT EXCEED THE RATED CAPACITY. NEVER APPLY EXCESSIVE FORCE TO A WORKPIECE AND ALWAYS USE THE PRESSURE GAUGE TO ACCURATELY DETERMINE THE APPLIED LOAD.
3. USE THIS PRESS FOR THE PURPOSE FOR WHICH IT IS INTENDED. DO NOT USE IT FOR ANY OTHER PURPOSE IT IS NOT DESIGNED TO PERFORM.
4. KEEP CHILDREN AND UNAUTHORIZED PERSONS AWAY FROM THE WORK AREA.
5. REMOVE ILL FITTING CLOTHING, REMOVE TIES, WATCHES, RINGS AND OTHER LOOSE JEWELRY, AND CONTAIN LONG HAIR.
6. WEAR ANTI-APPROVED IMPACT SAFETY GOGGLES, FULL-FACE IMPACT SAFETY SHIELD AND HEAVY-DUTY WORK GLOVES WHEN OPERATING THE PRESS.
7. KEEP PROPER BALANCE AND FOOTING, DO NOT OVERREACH AND WEAR NONSKID FOOTWEAR.
8. ONLY USE THIS PRESS ON A SURFACE THAT IS STABLE, LEVEL, DRY AND NOT SLIPPERY, AND CAPABLE OF SUSTAINING THE LOAD. KEEP THE SURFACE CLEAN, TIDY AND FREE FROM UNRELATED MATERIALS AND ENSURE THAT THERE IS ADEQUATE LIGHTING.
9. INSPECT THE PRESS BEFORE EACH USE, DO NOT USE IF BENT, BROKEN, CRACKED, LEAKING OR OTHERWISE DAMAGED, ANY SUSPECT PARTS ARE NOTED OR IT HAS BEEN SUBJECTED TO A SHOCK LOAD.
10. CHECK TO ENSURE THAT ALL APPLICABLE BOLTS AND NUTS ARE FIRMLY TIGHTENED.
11. ENSURE THAT WORKPIECE IS CENTER-LOADED AND SECURE.
12. KEEP HANDS AND FEET AWAY FROM BED AREA AT ALL TIMES.
13. DO NOT USE THE SHOP PRESS TO COMPRESS SPRING OR ANY OTHER ITEM THAT COULD DISengage AND CAUSE A POTENTIAL HAZARD. NEVER STAND DIRECTLY IN FRONT OF LOADED PRESS AND NEVER LEAVE LOADED PRESS UNATTENDED.
14. DO NOT OPERATE THE PRESS WHEN YOU ARE TIRED OR UNDER THE INFLUENCE OF ALCOHOL, DRUGS OR AN INHIBITING MEDICATION.
15. DO NOT ALLOW UNTRAINED PERSONS TO OPERATE THE PRESS.
16. DO NOT MAKE ANY MODIFICATIONS TO THE PRESS.
17. DO NOT USE BRAKE FLUID OR ANY OTHER IMPROPER FLUID AND AVOID MIXING DIFFERENT TYPES OF OIL WHEN ADDING HYDRAULIC OIL ONLY GOOD QUALITY HYDRAULIC JACK OIL CAN BE USED.
18. DO NOT EXPOSE THE PRESS TO RAIN OR ANY OTHER KIND OF BAD WEATHER.
19. IF THE PRESS NEEDS REPAIRING AND/OR THERE IS ANY PARTS THAT NEEDS TO BE REPLACED, HAVE IT REPAIRED BY AUTHORIZED TECHNICIANS AND ONLY USE THE REPLACEMENT PARTS SUPPLIED BY THE MANUFACTURER.
20. WARNING: THE WARNINGS, CAUTIONS AND INSTRUCTIONS DISCUSSED IN THIS INSTRUCTION MANUAL CANNOT COVER ALL POSSIBLE CONDITIONS AND SITUATIONS THAT MAY OCCUR. IT MUST BE UNDERSTOOD BY THE OPERATOR THAT COMMON SENSE AND CAUTION ARE FACTORS WHICH CANNOT BE BUILT INTO THIS PRODUCT, BUT MUST BE SUPPLIED BY THE OPERATOR.

II. SPECIFICATIONS

CAPACITY	30TON	STROKE	150MM
WORKING RANGE	130-820MM	BED WIDTH	530MM

III. ASSEMBLY

USE THE EXPLODED DRAWING AS YOUR GUIDE TO ASSEMBLE. LAY ALL PARTS AND ASSEMBLIES OUT IN FRONT OF YOU BEFORE BEGINNING.

THE FOLLOWING PROCEDURE IS RECOMMENDED:

1. ATTACH ONE BASE SECTION (23) TO LEFT POST AND LOWER CROSS MEMBER (20) USING BOLT (21), FLAT WASHER (19) THEN ATTACH ANOTHER TO RIGHT POST AND THE LOWER CROSS MEMBER.
2. PUT THE PRESS FRAME IN AN UPRIGHT POSITION, ATTACH ONE UPPER CROSSBEAM (3) TO LEFT AND RIGHT POST (14) USING BOLTS (4), FLAT WASHERS (5).
3. PUT ANOTHER UPPER CROSSBEAM (3) INTO POSITION AND INSERT THE UNDER PLATE (6) TO THE TWO UPPER CROSS BEAMS AT THE SAME TIME, THEN SECURE THIS CROSS BEAM TO THE POSTS USING BOLTS (4), FLAT WASHERS (5).
4. SCREW THE UNDER ROUND NUT (9) ONTO THE RAM ASSEMBLY (2), INSERT THE RAM INTO THE HOLE IN THE UNDER PLATE, AND ATTACH THE SERRATED SADDLE TO THE RAM.
5. INSERT ROD (17) INTO THE HOLES IN THE POSTS, AND THEN INSERT THE JOINED PRESS PLATE FROM (16) INTO PRESS FRAME AND ONTO BED FRAME PIN.
6. ATTACH THE RIGHT POST USING BOLTS (21), FLAT WASHER (19). THEN SECURE THE PUMP ASSEMBLY (12), AND THEN INSERT THE HANDLE TO THE HANDLE BRACKET.
7. TIGHTEN ALL BOLTS AND SCREWS

IV. BEFORE FIRST USE

1. NOTE: BEFORE FIRST USE OF THIS PRODUCT, PURGE AWAY AIR FROM THE HYDRAULIC SYSTEM; OPEN THE RELEASE VALVE BY TURNING IT COUNTERCLOCKWISE. PUMP SEVERAL FULL STROKES TO ELIMINATE ANY AIR IN THE SYSTEM.
2. CHECK ALL PARTS AND CONDITIONS, IF THERE IS ANY PART BROKEN, STOP USING IT AND CONTACT YOUR SUPPLIER IMMEDIATELY.

V. OPERATING INSTRUCTIONS

WARNING! ENSURE THAT YOU READ, UNDERSTAND AND APPLY THE SAFETY INSTRUCTIONS AND WARNINGS BEFORE USE.

1. PLACE THE HEEL BLOCK (15) ON PRESS PLATE FROM (16), THEN INSERT WORKPIECE ONTO THE HEEL BLOCK.
2. CLOSE THE RELEASE VALVE BY TURNING IT CLOCKWISE UNTIL IT IS FIRMLY CLOSED.
3. PUMP THE HANDLE UNTIL SERRATED SADDLE NEARS WORKPIECE.
4. ALIGN WORKPIECE AND RAM TO ENSURE CENTER-LOADING.
5. PUMP THE HANDLE TO APPLY LOAD ONTO WORKPIECE
6. WHEN WORK IS DONE, STOP PUMPING THE HANDLE, SLOWLY AND CAREFULLY REMOVE LOAD FROM WORKPIECE BY TURNING THE RELEASE VALVE COUNTERCLOCKWISE IN SMALL INCREMENTS.
7. ONCE RAM HAS FULLY RETRACTED, REMOVE WORKPIECE FROM BED FRAME.

VI. MAINTENANCE

1. CLEAN THE OUTSIDE OF THE PRESS WITH DRY, CLEAN AND SOFT CLOTH AND PERIODICALLY LUBRICATE THE JOINTS AND ALL MOVING PARTS WITH A LIGHT OIL AS NEEDED.
2. WHEN NOT IN USE, STORE THE PRESS IN A DRY LOCATION WITH RAM AND PISTON FULLY RETRACTED.
3. WHEN PRESS EFFICIENCY DROPS, PURGE THE HYDRAULIC SYSTEM TO ELIMINATE ANY AIR IN THE SYSTEM AS DESCRIBED IN IV.